

An aerial photograph of a campus. In the foreground, a large, modern building with a flat roof and a series of steps leading up to it is visible. The building is surrounded by lush green trees. In the background, a river flows through a dense forest of tall trees. The sky is clear and blue.

INTEGRATED LEARNING RESOURCES CENTER DESIGN DEVELOPMENT

College of Marin | Board of Trustees | October 2021

GROUP 4
ARCHITECTURE
HMC Architects

AGENDA

1. Project Schedule & Engagement
2. Design Responses & Refinements
3. Project Budget
4. Exterior Design
5. Interior Design

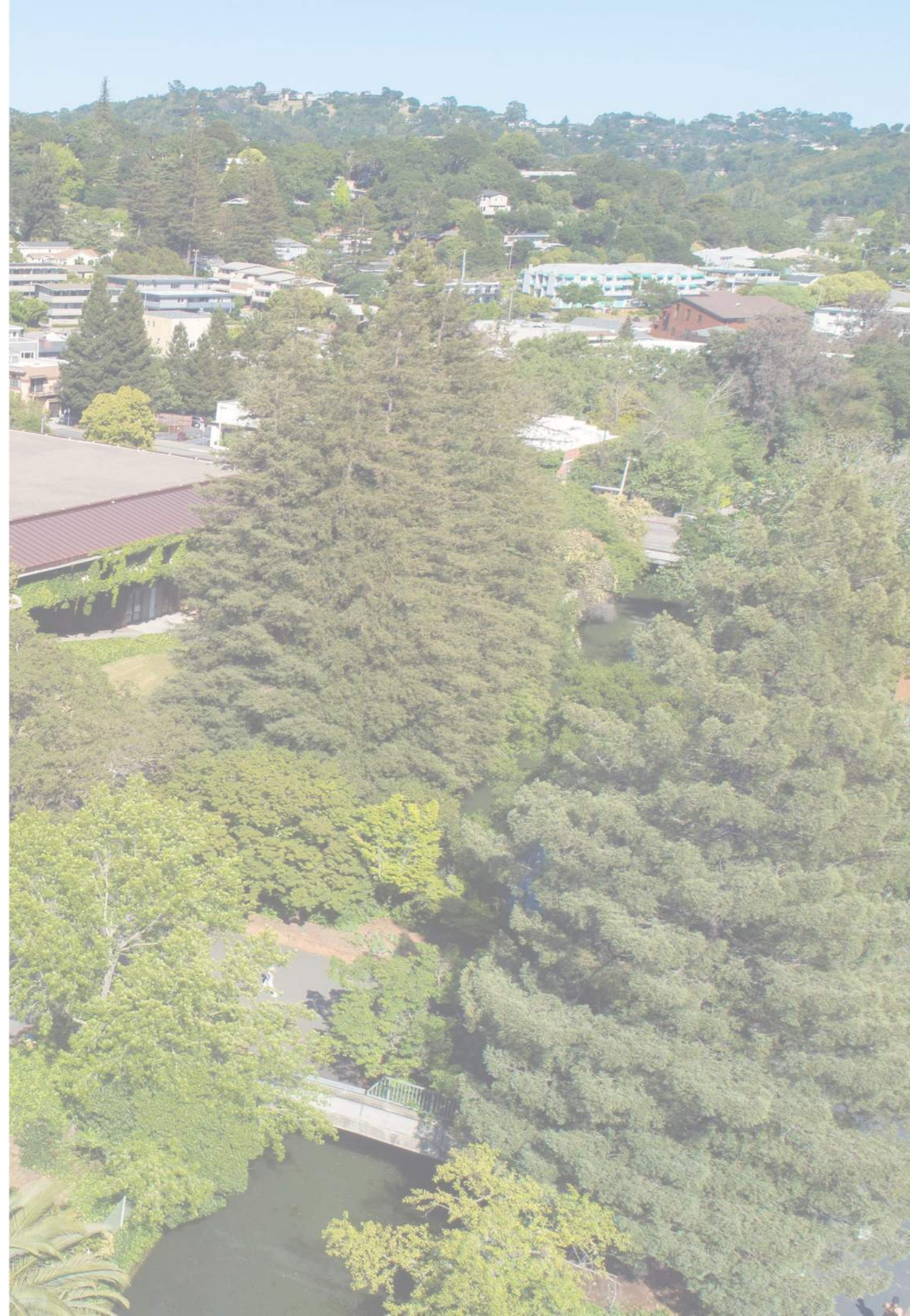

PROJECT SCHEDULE

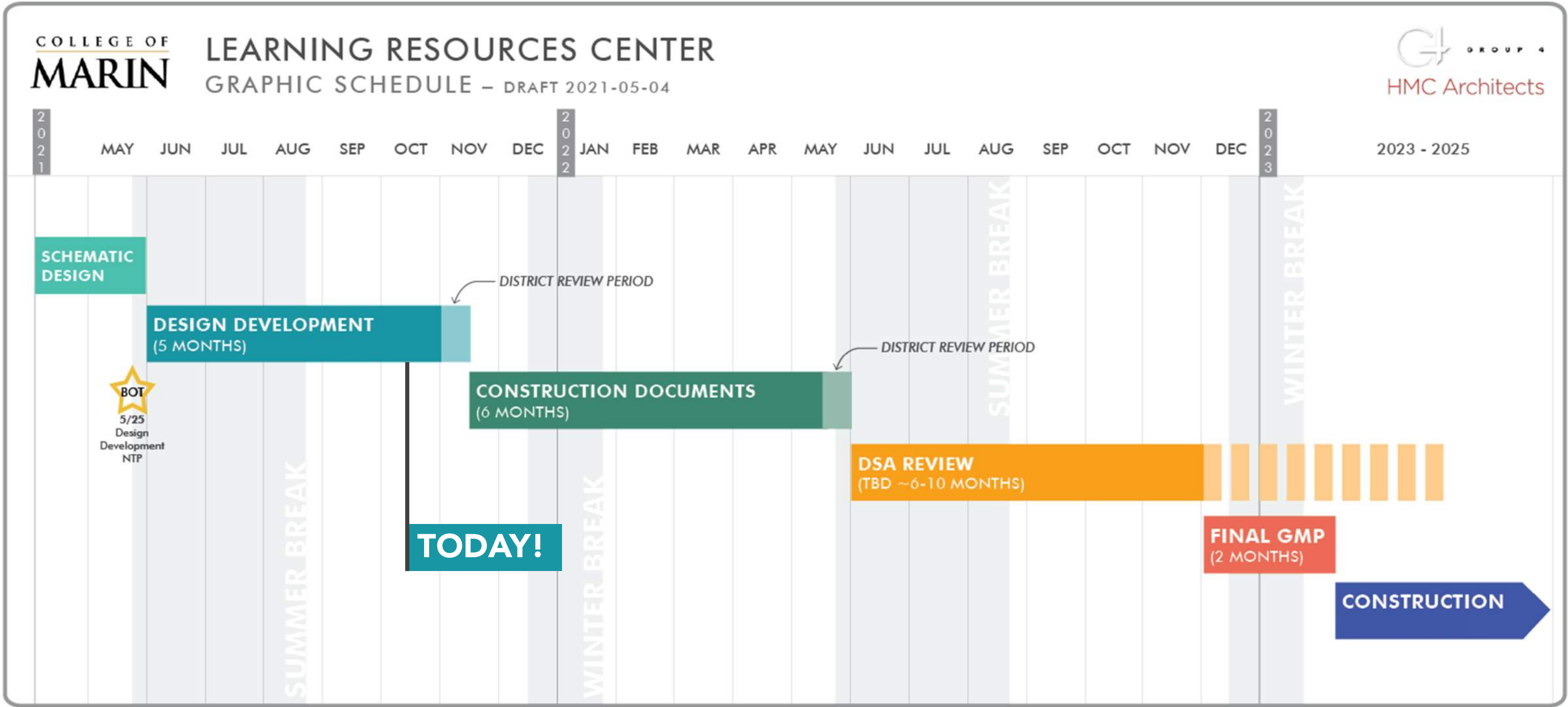

TECHNICAL MEETINGS

- Working Group
- Learning Support Services
- Faculty – Classroom Design
- Faculty – Computer Classroom Design
- Student Activities + Advocacy
- ESCOM
- Library Staff
- EOPS
- Tutoring, Reading & Writing
- Learning Communities

- International Education
- Wellness
- Transfer Center
- Counseling
- Faculty Development
- Information Technology
- Operations & Maintenance

PUBLIC MEETINGS

- COM Hour
- Town Hall

PUBLIC AUTHORITIES

- Kentfield Fire Protection District
- Kentfield Planning Advisory Board
- Division of the State Architect

UPCOMING ENGAGEMENT

- Working Group
- Facilities Planning Committee
- Academic Senate
- Classified Senate (10/15)
- ASCOM
- KPAB (2nd meeting of the phase)
- DSA (11/1)
- Board of Trustees (11/9)

BUILDER COORDINATION

- Alten Construction (LLB Contractor)

AGENDA

1. Project Schedule & Engagement
2. Design Responses & Refinements
3. Project Budget
4. Exterior Design
5. Interior Design

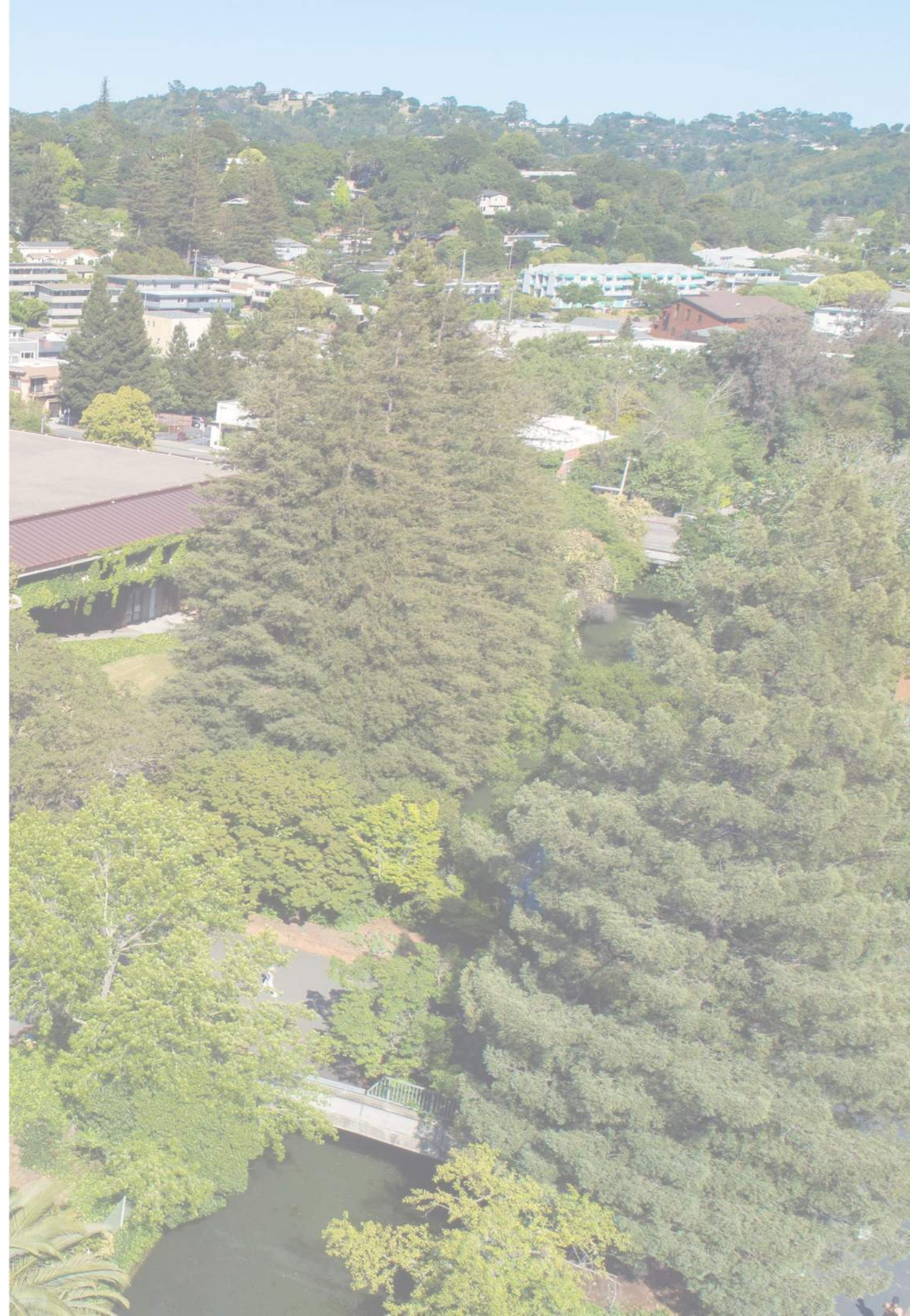

DESIGN VALUES

WARM + CASUAL



WARM + COMFORTABLE



ECOLOGICAL + ORGANIC



BUILDING DESIGN VALUES

NATURALISTIC



INFORMAL



SITE DESIGN VALUES

COLOR + MATERIAL
PALETTES TO BE REVIEWED
IN NEXT ROUND OF
ENGAGEMENT

RESPONSE TO 5/11 BOARD INPUT

PROTECT CORE PROGRAM

- Build to budget without further area reductions

DESIGN SUSTAINABLY

- High performance building designed to meet code
- Operational responses to environmental challenges through campus protocols

FUTURE FLEXIBILITY

- Constructable and Maintainable
- Anticipate future technology, AV

CONSIDER HUMAN SCALE

- Active College Avenue
- Protect entrances



*These images are conceptual renderings and are not intended to be a final product of design. Final design shall be approved by the Board of Trustees.
Note: signage and railing designs to be determined in later phases*

REFINEMENTS SINCE SD

EXTERIOR

- Added canopies at entry doors
- Extended roof overhang
- Removed extensive sunshades
- Added stone tile accents
- Revised skylights
- Selected shallow foundations
- Refined roof shape

INTERIOR

- Refined floor plan arrangement
- All-Gender restrooms
- Rearranged classrooms
- Removed phone booths
- Added Huddle rooms
- Removed (1) operable partition
- Clarified café space

AGENDA

1. Project Schedule & Engagement
2. Design Responses & Refinements
3. Project Budget
4. Exterior Design
5. Interior Design

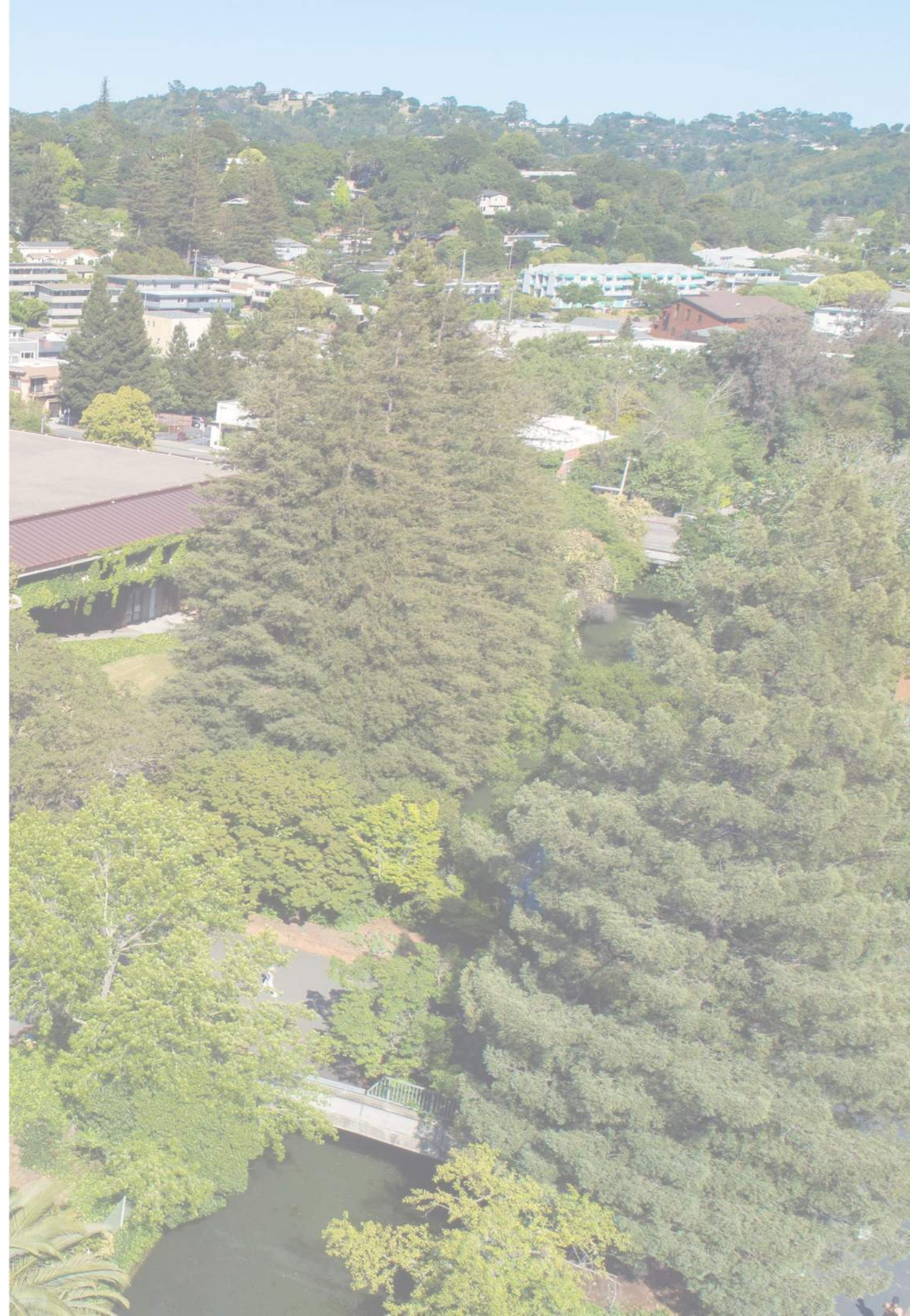

PROJECT BUDGET

PROJECT IS ON BUDGET

- GMP: \$82,325,000 +/-
- Building Area: 75,000 +/- GSF
- Protects Core Program

BUDGET INCLUDES

- High performance building designed to code
- Flexible AV vetted by faculty, IT staff
- Basic café equipment
- Library shelving
- Archaeological Mitigation (\$3.5M)

BUDGET EXCLUDES

- Furniture & Equipment
- Wayfinding & Graphics
- Generator



*These images are conceptual renderings and are not intended to be a final product of design. Final design shall be approved by the Board of Trustees.
Note: signage and railing designs to be determined in later phases*

UNIFY

FIT

INSPIRE



SITE PLAN

GLADE

SHADE
PLAZA

VIEW
PLAZA

COLLEGE

SOCIAL
SLOPE

CREEKSIDE

COLLEGE AVE

COLLEGE
PORTAL

This image is a conceptual rendering and is not intended to be a final product of design. Final design shall be approved by the Board of Trustees.
Note: signage and railing designs to be determined in later phases

FLOOR PLANS

1ST FLOOR CREEKSIDE

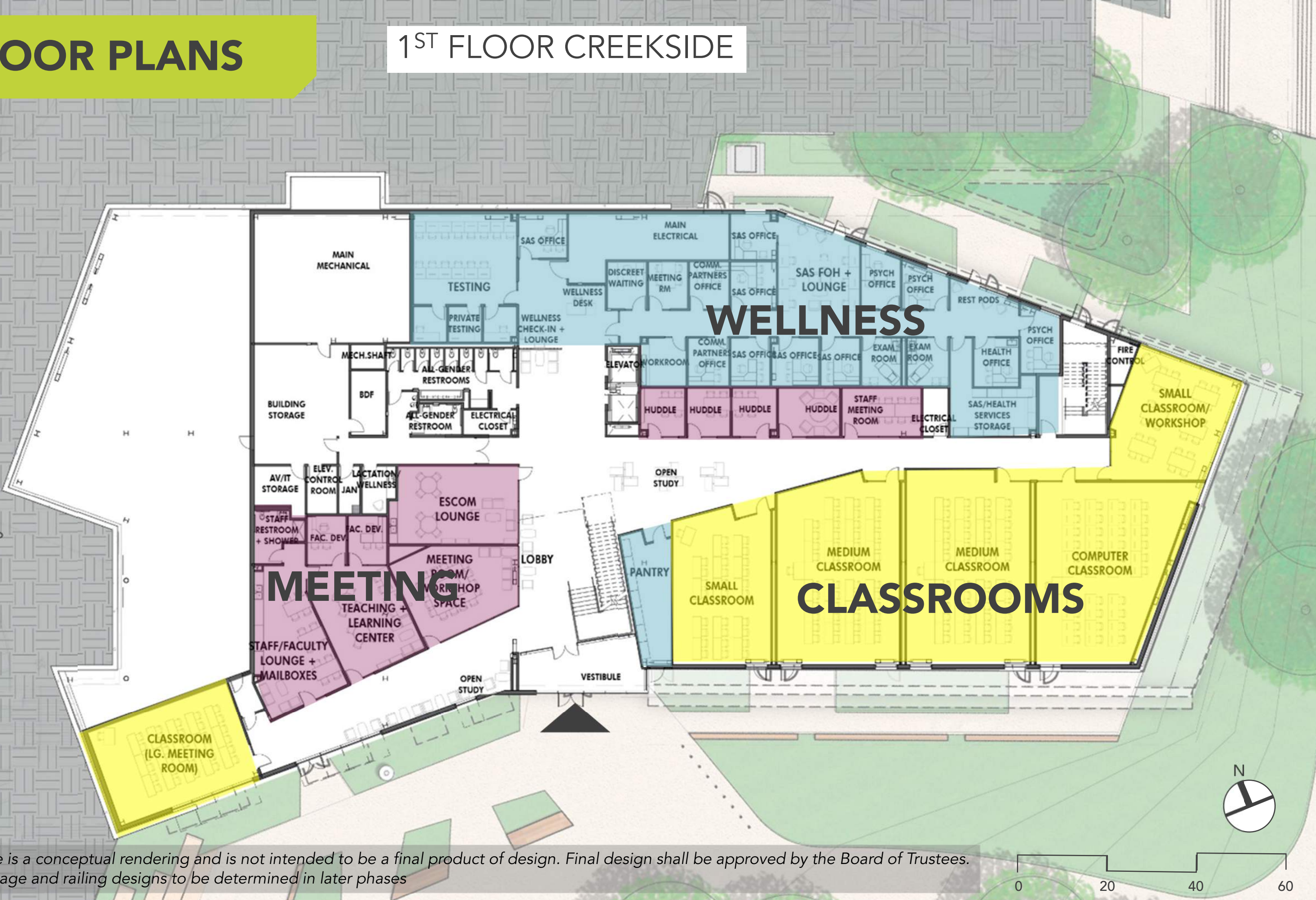

This image is a conceptual rendering and is not intended to be a final product of design. Final design shall be approved by the Board of Trustees.
Note: signage and railing designs to be determined in later phases

FLOOR PLANS

2ND FLOOR GLADE

CLASSROOMS

LIBRARY

SUPPORT

OUTDOOR DECK

This image is a conceptual rendering and is not intended to be a final product of design. Final design shall be approved by the Board of Trustees.
Note: signage and railing designs to be determined in later phases

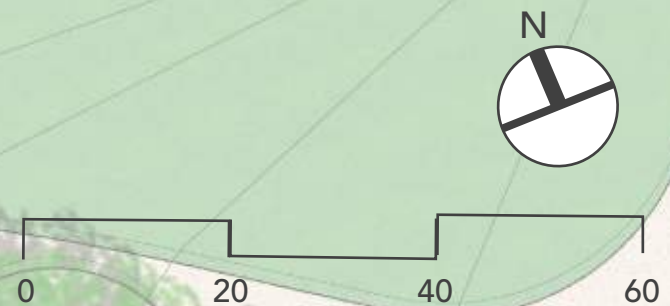

FLOOR PLANS

3RD FLOOR TAM

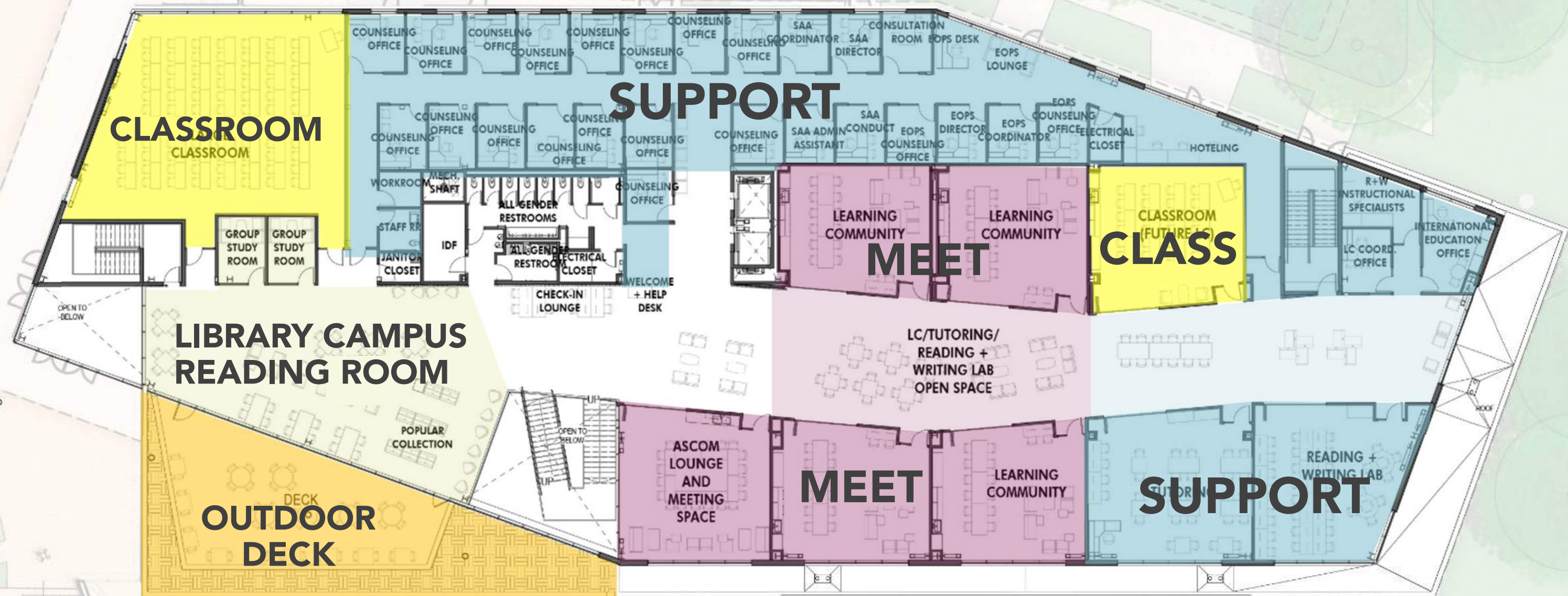

This image is a conceptual rendering and is not intended to be a final product of design. Final design shall be approved by the Board of Trustees.
Note: signage and railing designs to be determined in later phases

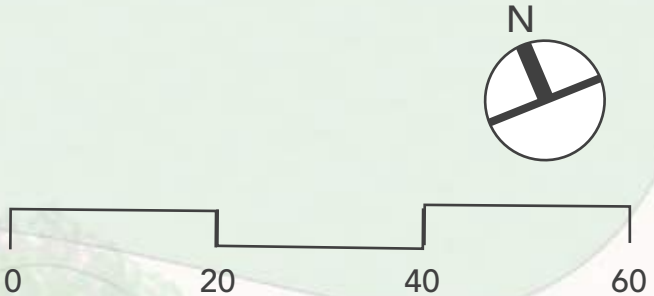

AGENDA

1. Project Schedule & Engagement
2. Design Responses & Refinements
3. Project Budget
4. Exterior Design
5. Interior Design

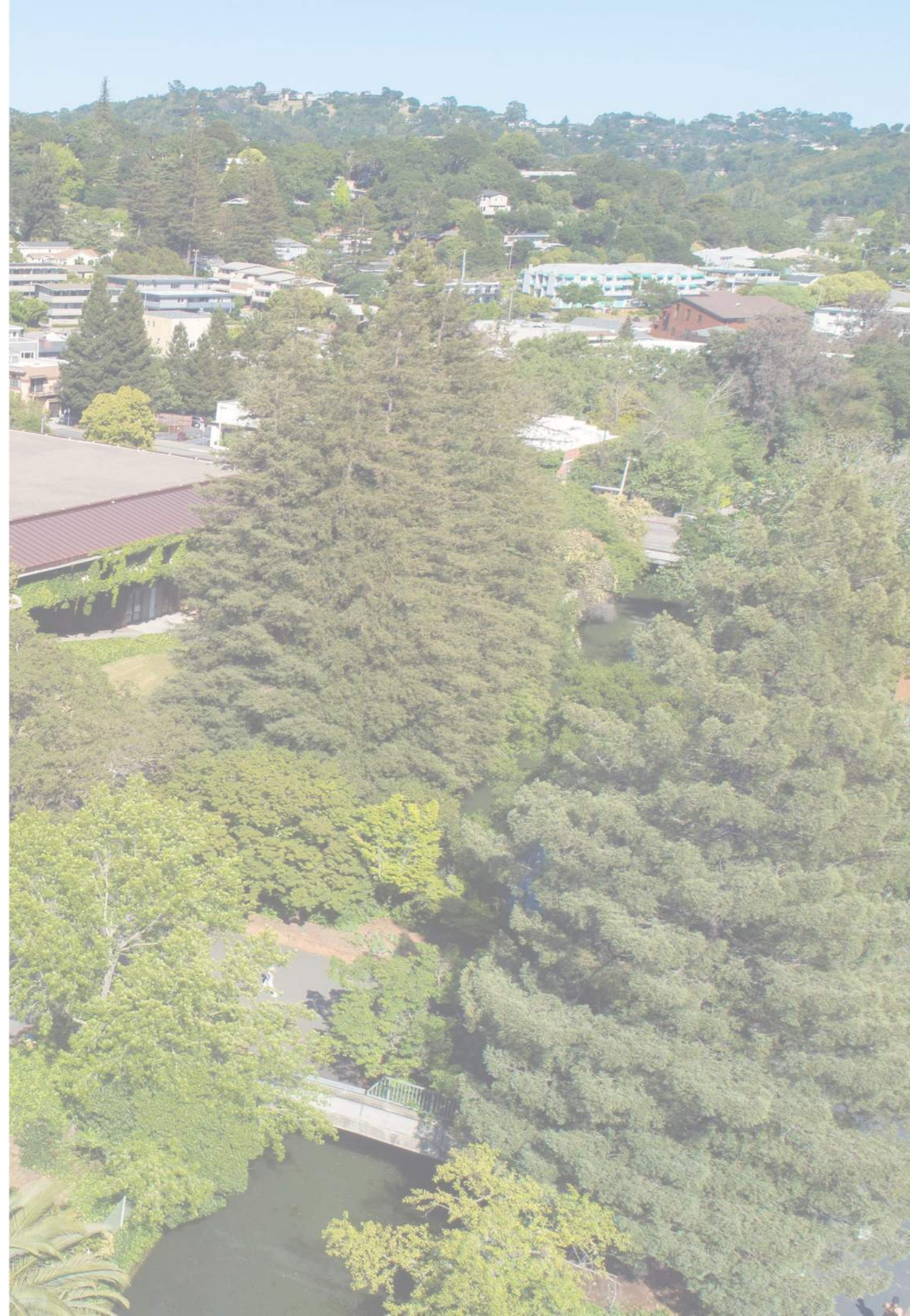



This image is a conceptual rendering and is not intended to be a final product of design. Final design shall be approved by the Board of Trustees.

Note: signage and railing designs to be determined in later phases

CAMPUS ENTRY FROM CREEK & PARKING



This image is a conceptual rendering and is not intended to be a final product of design. Final design shall be approved by the Board of Trustees.

Note: signage and railing designs to be determined in later phases

SOCIAL SLOPE



This image is a conceptual rendering and is not intended to be a final product of design. Final design shall be approved by the Board of Trustees.

Note: signage and railing designs to be determined in later phases

GLADE ENTRY + TOP OF SOCIAL SLOPE



This image is a conceptual rendering and is not intended to be a final product of design. Final design shall be approved by the Board of Trustees.

Note: signage and railing designs to be determined in later phases

EVENT SPACE TERRACE + NORTH ENTRY



This image is a conceptual rendering and is not intended to be a final product of design. Final design shall be approved by the Board of Trustees.

Note: signage and railing designs to be determined in later phases

GLADE VIEW



This image is a conceptual rendering and is not intended to be a final product of design. Final design shall be approved by the Board of Trustees.

Note: signage and railing designs to be determined in later phases

VIEW WEST AT COLLEGE AVENUE STEPS



This image is a conceptual rendering and is not intended to be a final product of design. Final design shall be approved by the Board of Trustees.

Note: signage and railing designs to be determined in later phases

CREEKSIDE ENTRY



This image is a conceptual rendering and is not intended to be a final product of design. Final design shall be approved by the Board of Trustees.

Note: signage and railing designs to be determined in later phases

VIEW NORTH ON COLLEGE AVENUE

EXTERIOR MATERIAL PALETTE

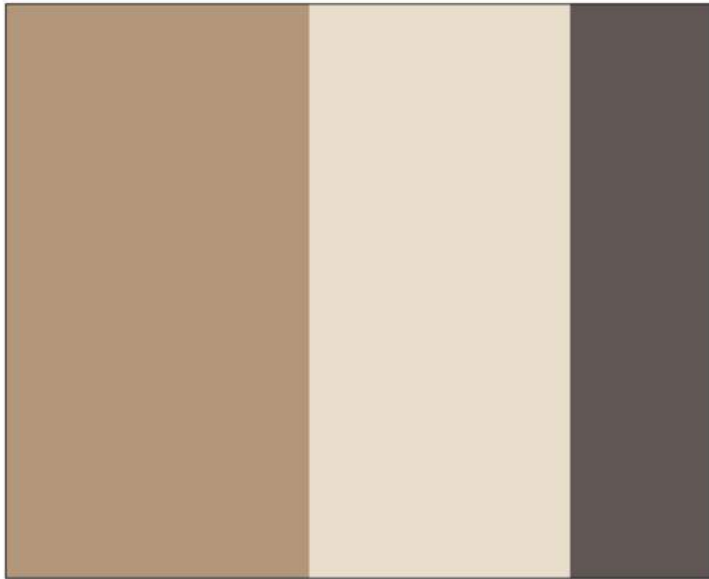

PT -1

PT -2

PT -3

PT -1 - INSULATED PORTLAND CEMENT PLASTER SYSTEM W/ SAND FINISH PTD
PT -2 - INSULATED PORTLAND CEMENT PLASTER SYSTEM W/ SAND FINISH PTD
PT -3 - EXPOSED STRUCTURAL ELEMENTS

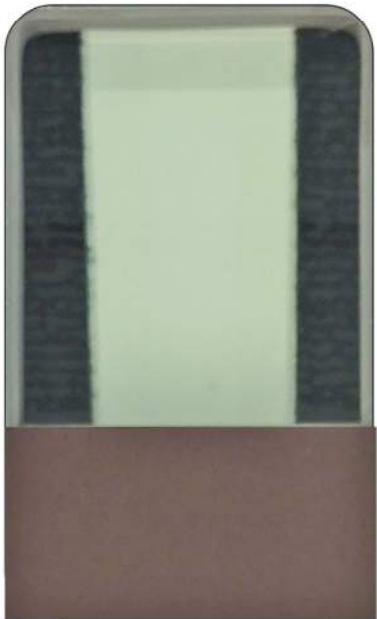

GL -1

AL -1

GL -1 - VISION GLASS - 1" INSULATED GLAZING UNIT W/ LOW - E COATING
AL -1 - CURTAIN WALL, STOREFRONT AND SKYLIGHT MULLIONS



GL -2

SP -1

GL -2 - SKYLIGHT GLASS - 1" INSULATED GLAZING UNIT W/ LOW - E COATING

SP -1 SINGLE PLY PVC ROOFING W/ WELDED BATTENS

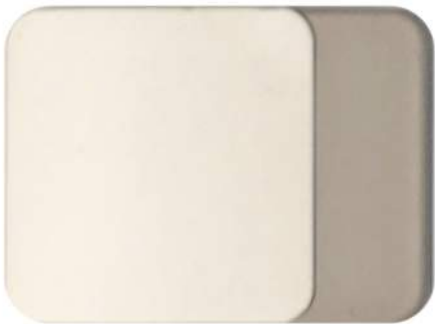

ACM -1/ AL-2

ACM -2

ACM -1 - METAL COMPOSITE PANEL SYSTEM, LIGHT GRAY
ACM -2 - METAL COMPOSITE PANEL SYSTEM, DARK GRAY
AL -2 - HORIZONTAL ALUMINUM SHADING



ACM -3

ACM -3 - METAL COMPOSITE PANEL SYSTEM, WHITE
ADD ALTERNATE @ 3RD FLOOR



ST -1

ST -1 - STONE CLADDING
ADD ALTERNATE @ ENTRANCES

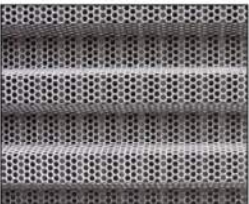

CMP -1- PERFORATED CORRUGATED METAL PANEL SCREEN



EXTERIOR RENDERING

AGENDA

1. Project Schedule & Engagement
2. Design Responses & Refinements
3. Project Budget
4. Exterior Design
5. Interior Design

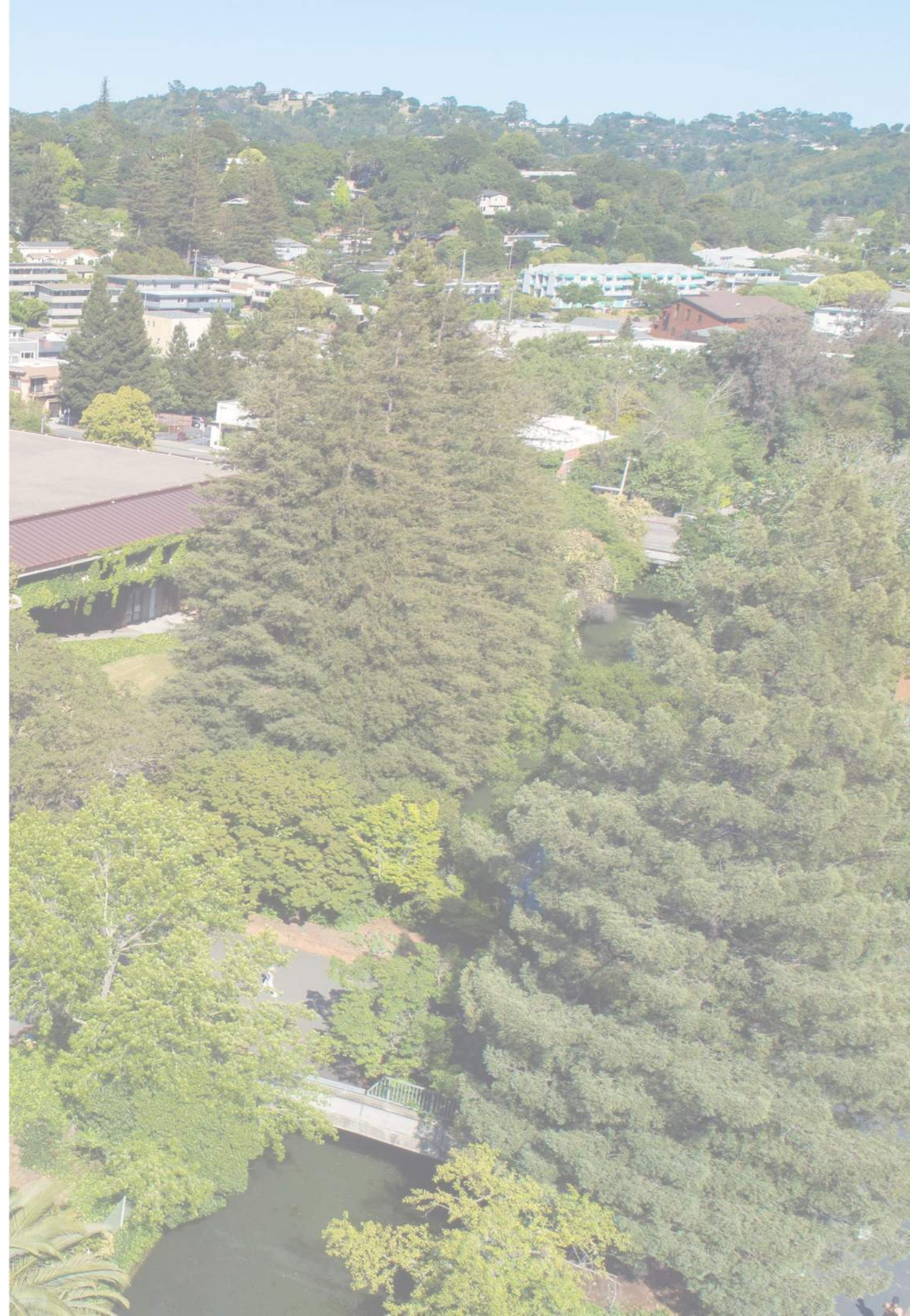



This image is a conceptual rendering and is not intended to be a final product of design. Final design shall be approved by the Board of Trustees.

Note: signage and railing designs to be determined in later phases

CREEKSIDE ENTRY



This image is a conceptual rendering and is not intended to be a final product of design. Final design shall be approved by the Board of Trustees.

Note: signage and railing designs to be determined in later phases

GLADE ENTRY + FOOD SERVICE



This image is a conceptual rendering and is not intended to be a final product of design. Final design shall be approved by the Board of Trustees.

Note: signage and railing designs to be determined in later phases

CAMPUS READING ROOM



This image is a conceptual rendering and is not intended to be a final product of design. Final design shall be approved by the Board of Trustees.

Note: signage and railing designs to be determined in later phases

LEARNING SUPPORT SERVICES

EXTERIOR FLYTHROUGH

INTERIOR FLYTHROUGH



THANK YOU!

